



ALLIANCE™

FIXED RESILIENT

**FIXED
RESILIENT**
○ ○ ○
ALLIANCE

SYSTEM FEATURES AND BENEFITS

An anchored sports floor system providing adjustable performance levels, consisting in general of a vapor barrier, pre-manufactured subfloor panels adjusted as specified, anti-squeak collared steel anchors, resilient Rezill pads, maple flooring, sanding, sealers, finishes, game lines, and wall base.

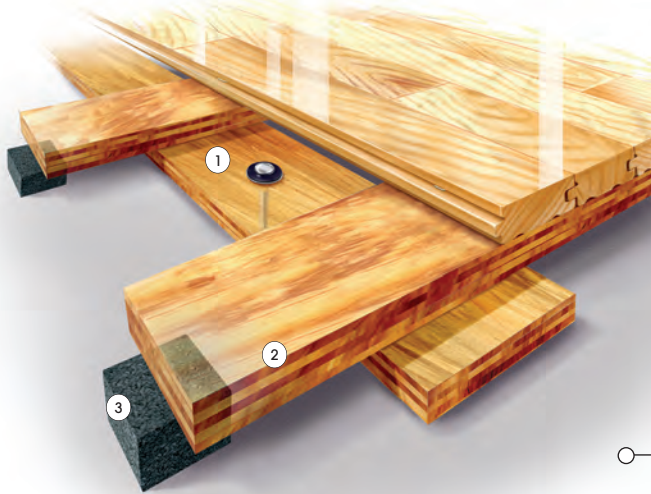

- ① Heavy Duty concrete anchors with Anti-Squeak Collar
- ② Pre-manufactured subfloor assemblies
- ③ Resilient Rezill Pads

SPECIFICATIONS

MANUFACTURING	ISO 9001:2000 CERTIFIED
SYSTEM TYPE	Fixed Resilient
ANCHORAGE	Singular Pinned (Design Group 3)
SUBFLOOR CONSTRUCTION	Sleeper Panel
RESILIENCE	Rezill Pads
RECYCLED CONTRIBUTION	Alliance Subfloor System includes components with recycled content
SLAB DEPRESSION	25/32" (20 mm) flooring - 2 1/4" (57 mm) 33/32" (26 mm) flooring - 2 1/2" (64 mm)
DIN STATUS	D-I-N Meets or exceeds all the requirements of DIN 18032, part 2
TESTING LABORATORY	United States Sports Surfacing Laboratory
CERTIFIED TESTING	Laboratory test equipment calibrated and certified through the ISSS
GREEN STATUS	Managed forests, certification available

WALL BASE DETAIL

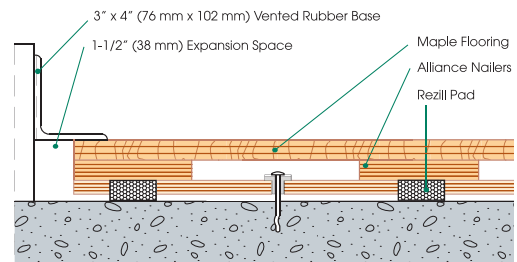

THRESHOLD DETAIL (optional accessory)

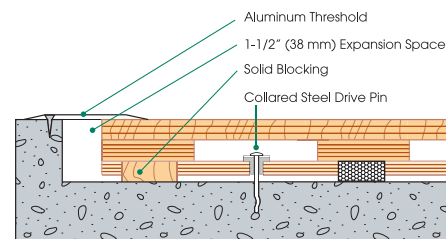

EQUIPMENT DETAIL (optional accessory)

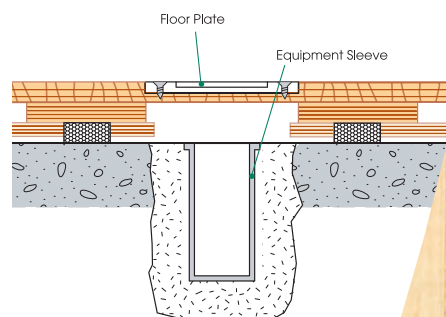

©2010 Connor is a registered trademark of Connor Sport Court International

connorfloor.com
1.800.283.9522