



# DURACUSHION™ I

**FLOATING SYSTEM**  
 ○ ○ ○  
 DURACUSHION I

## F L O A T I N G   S Y S T E M

### SYSTEM FEATURES AND BENEFITS

A floating sports floor system providing shock absorption, consisting in general of a vapor barrier, PVC pads, wood subflooring, maple flooring, sanding, sealers, finishes, game lines and wall base.

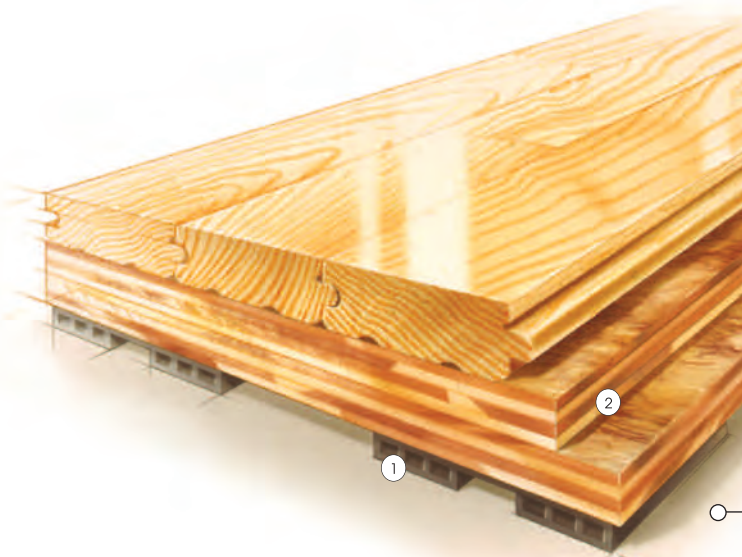

- ① 3/8" Duracushion PVC resilient pads
- ② Two layers of 15/32" APA rated plywood subfloor

### SPECIFICATIONS

<b>MANUFACTURING</b>	<b>ISO9001:2008</b> CERTIFIED
<b>SYSTEM TYPE</b>	Floating System
<b>ANCHORAGE</b>	No concrete attachment
<b>SUBFLOOR CONSTRUCTION</b>	Plywood Panel
<b>RESILIENCE</b>	PVC Pads
<b>SLAB DEPRESSION</b>	3/8" (10 mm) pad: 25/32" (20 mm) flooring - 2 1/8" (54 mm) 33/32" (26 mm) flooring - 2 3/8" (60 mm)  5/8" (10 mm) pad: 25/32" (20 mm) flooring - 2 3/8" (60 mm) 33/32" (26 mm) flooring - 2 5/8" (67 mm)
<b>TESTING LABORATORY</b>	United States Sports Surfacing Laboratory
<b>CERTIFIED TESTING</b>	ISSS Scientific Body Member Laboratory Testing
<b>GREEN STATUS</b>	Managed forests, certification available



#### WALL BASE DETAIL

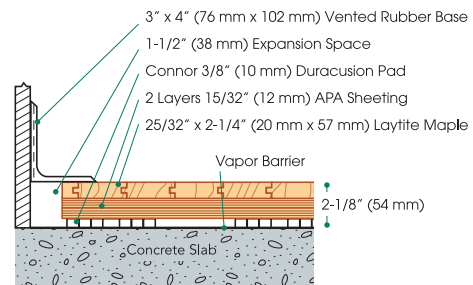

#### THRESHOLD DETAIL (optional accessory)

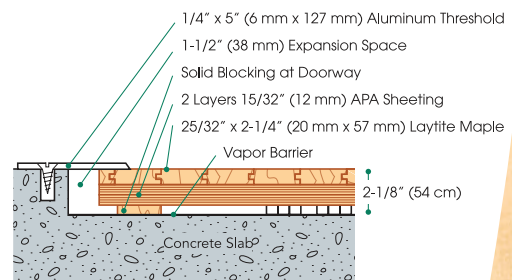

#### EQUIPMENT DETAIL (optional accessory)

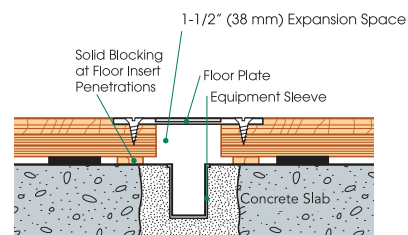

©2010 Connor is a registered trademark of Connor Sport Court International

**connorfloor.com**  
**1.800.283.9522**