



# DURACUSHION II™

FLOATING SYSTEM  
DURACUSHION II

## F L O A T I N G S Y S T E M

### SYSTEM FEATURES AND BENEFITS

Floating sports floor system providing shock absorption, consisting in general of a vapor barrier, PVC pads, softwood nailers, maple flooring, sanding, sealers, finishes, game lines and wall base.



- ① 3/8" (10 mm) Duracushion PVC resilient pads
- ② Nominal 2"x 3" (38 mm x 64 mm) Softwood Sleeper

### SPECIFICATIONS

<b>MANUFACTURING</b>	ISO 9001:2000 CERTIFIED
<b>SYSTEM TYPE</b>	Floating System
<b>ANCHORAGE</b>	No concrete attachment
<b>SUBFLOOR CONSTRUCTION</b>	Sleeper
<b>RESILIENCE</b>	PVC Pads
<b>SLAB DEPRESSION</b>	3/8" (10 mm) pad: 25/32" (20 mm) flooring - 2 5/8" (67 mm) 33/32" (26 mm) flooring - 2 7/8" (73 mm)  5/8" (16 mm) pad: 25/32" (20 mm) flooring - 2 7/8" (73 mm) 33/32" (26 mm) flooring - 3 1/8" (79 mm)
<b>TESTING LABORATORY</b>	United States Sports Surfacing Laboratory 
<b>CERTIFIED TESTING</b>	Laboratory test equipment calibrated and certified through the ISSS 
<b>GREEN STATUS</b>	Managed forests, certification available.

#### WALL BASE DETAIL

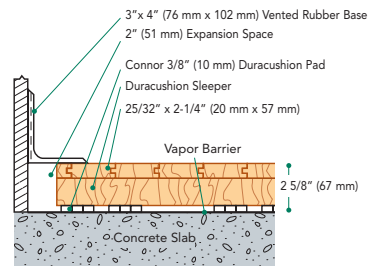

#### THRESHOLD DETAIL (optional accessory)

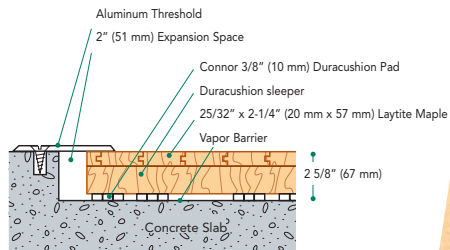

#### EQUIPMENT DETAIL (optional accessory)

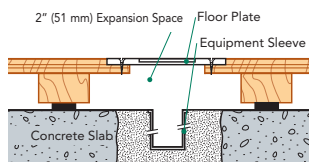

connorfloor.com  
1.800.283.9522

©2006 Connor is a registered trademark of Connor Sport Court International