

F I X E D R E S I L I E N T

SYSTEM FEATURES AND BENEFITS

A sports floor system providing the stability of an anchored floor with the uniform resiliency of a floating system, consisting in general of a vapor barrier, resilient pads, steel channel, steel anchors, wood subflooring, maple flooring, sanding, sealers, finishes, game lines and wall base.



- ① Heavy-duty, buckle resistant steel channel provides great resistance to pin pull through and upward pressure
- ② Rezill Pad for excellent resilient life and loading
- ③ Two layers APA rated plywood sheeting

SPECIFICATIONS

| | |
|-----------------------|---|
| MANUFACTURING | ISO 9001:2000 CERTIFIED |
| U.S. PATENT # | Pending |
| SYSTEM TYPE | Fixed Resilient |
| ANCHORAGE | Sectional Channel (Design Group 2) |
| SUBFLOOR CONSTRUCTION | Plywood Panel |
| RESILIENCE | Rezill Pads |
| SLAB DEPRESSION | 25/32" (20 mm) flooring – 2" (51mm) 33/32" (26mm) flooring – 2 1/4" (57mm) |
| DIN STATUS | D·I·N Meets or exceeds all requirements of DIN 18032, Part 2, 2001 |
| TESTING LABORATORY | United States Sports Surfacing Laboratory |
| CERTIFIED TESTING | Laboratory test equipment calibrated and certified through the ISSS |
| GREEN STATUS | Managed forests, certification available |

WALL BASE DETAIL

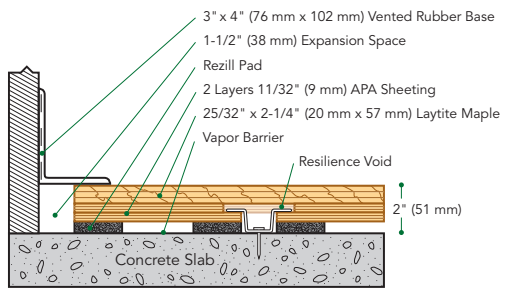

THRESHOLD DETAIL (optional accessory)

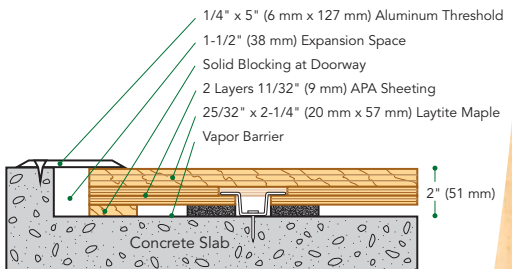

EQUIPMENT DETAIL (optional accessory)

